

DIFFUSER SET-UP

- 1** Remove diffuser from the box and gently pull the diffuser aeration tubing loose. Unwrap the three stainless steel arms.
- 2** Slip the end of arm opposite the orange clip into the notch on the diffuser base. Ensure the orange clip is facing up.
- 3** Align the hole in base and arm. Insert screw and tighten. Repeat this step with the other two arms.
- 4** Press diffuser aeration tubing into the orange plastic clip at the end of each diffuser arm.

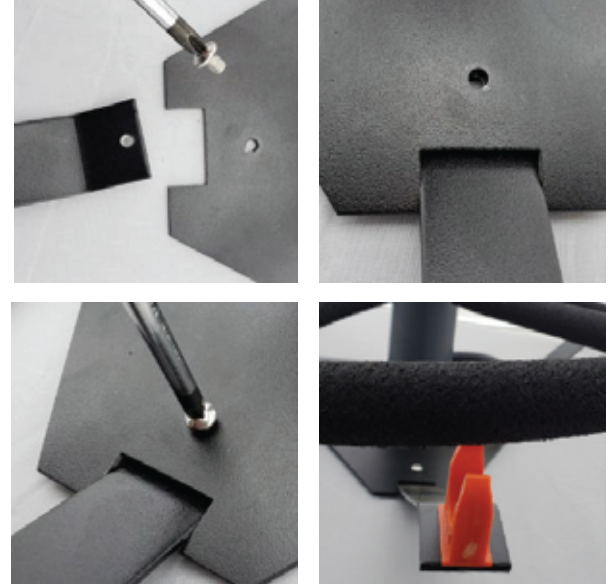

PRE-INSTALLATION

A short 3/8" I.D. piece of sinking airline with a hose barb has been pre-installed on the diffuser. Attach the inside end of the 100' roll of 3/8" I.D. sinking airline to this short piece using the hose clamp provided. Tighten the hose clamp using a socket/nut driver or flat head screwdriver. Do not over tighten clamp.

If a boat is being used (preferred) for diffuser placement, tie a rope to the three outer holes to allow you to drop the diffuser down to the bottom. Always use a flat-bottomed, stable boat and avoid using a canoe or other vessel that may tip.

If no boat is available (this only works for 100' of airline or less), tie a rope to one of the outer diffuser holes and pull diffuser into position with 100' of sinking airline attached. Always ensure that there is adequate slack on the sinking airline. Never pull the diffuser by the sinking airline.



WHEN FISH ARE PRESENT

- Do not install the diffuser directly on the bottom.
A float with enough buoyancy to suspend the diffuser will be needed.
- Install your diffuser(s) at half-depth to not disturb the bottom and cause the anaerobic sludge to mix with the water.
- Lower it by 2' every second week until it is on the bottom.

INSTALLATION

Consider where the Can-Air Diffuser(s) are to be located in the pond. Proper placement is the key for aeration efficiency. If using more than one diffuser, space the diffusers equally from one another in a depth that embodies the majority of the pond.

It is recommended to place a buoy for each diffuser to mark the area that it is to be placed.

- 1** Load your boat with the pre-assembled diffuser and the 100' roll of 3/8" I.D. sinking airline already attached. If the diffuser is more than 100' from the compressor, additional rolls of 1/2" I.D. sinking airline will be required. For every extra roll of sinking airline, you will need one hose barb connector and two hose clamps. Bring a nut driver or flat screwdriver to tighten clamps.



Optional: connect rope to three arms of diffuser for easier retrieval.

Pre-assembled float kits (pictured) are available for easy install.

CAUTION: During installation do not use boats that tip easily. Always follow all boating safety rules and regulations, including wearing a personal flotation device.

- 2** Position boat near the desired diffuser location. Slowly lower the diffuser into the water in an upright position. Use the [optional] rope to guide the diffuser, or release the diffuser at the surface and allow it to sink to the bottom naturally (it is self-righting). Always ensure that there is a sufficient amount of airline to avoid strain on the connection when dropping the diffuser.
- 3** Slowly make your way back to shore, unspooling the airline as you go. Never put tension or strain on the airline.
- 4** Securely connect to the heat rated airline at the compressor or insulated line using a hose clamp. If the aeration system contains multiple diffusers, repeat these steps for every diffuser. Once everything is hooked up correctly, your diffusers are ready to aerate!

DIFFUSER MAINTENANCE

Can-Air diffusers require minimal maintenance. For optimal performance, Pond Pro recommends diffusers to be rebuilt every 5-7 years, or as needed.

How to tell if your diffuser needs a rebuild?

- It has been over 5 years since it was installed
- Large bubbles are produced by the diffuser
- The diffuser appears weaker in performance

☎ 1-855-414-7663

✉ SALES@PONDPRO.CA

📍 CAMROSE, AB

🌐 PONDPRO.CA

